

Brook Road Allotments

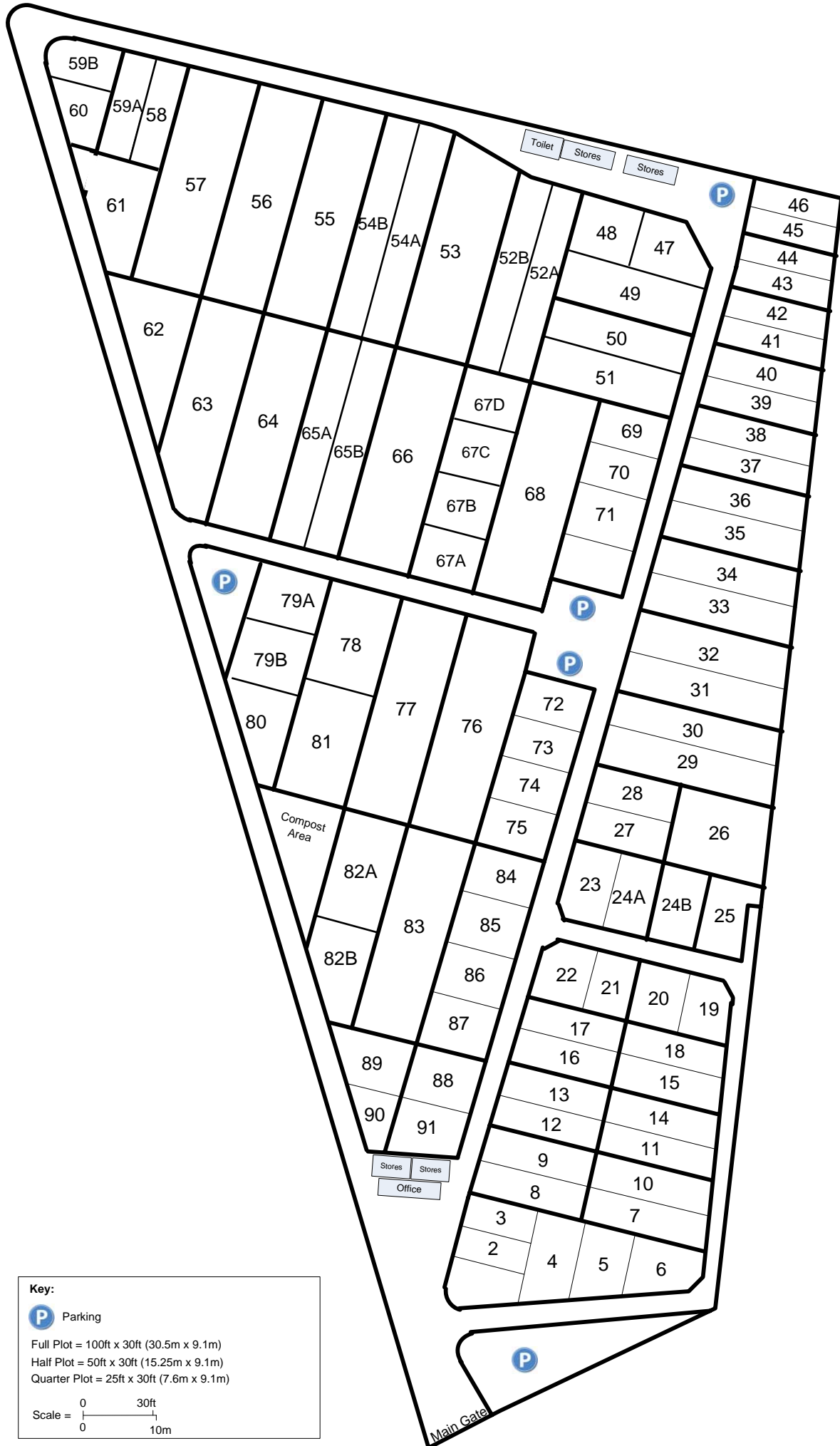

Key:

P Parking

Full Plot = 100ft x 30ft (30.5m x 9.1m)
 Half Plot = 50ft x 30ft (15.25m x 9.1m)
 Quarter Plot = 25ft x 30ft (7.6m x 9.1m)

Scale = $\frac{0}{0}$ $\frac{30ft}{10m}$